

# Winnetka, Illinois

## Commercial Districts

### Streetscape and Wayfinding Implementation Plan



**WINNETKA STREETSCAPE COMMITTEE**

**THE LAKOTA GROUP**

October 2008

## Priority 1 Implementation Plan

Following the preparation of the Preliminary Master Streetscape and Wayfinding Plan, the Streetscape Committee presented the draft plan to the Village Council for review in October 2007. In April, 2008, at the direction of Village Council, the Committee was asked to reconvene and prepare a *Priority 1 Implementation Plan*; a Plan that would recommend an initial phase of streetscape development that was both cost effective, and achievable within a reasonable time frame.

The Committee discussed goals of the *Priority 1 Implementation Plan* and created a Plan that met the following objectives:

- **Has the benefit of public input and support**
- **Provides the greatest impact and value to the community by focusing on high-visibility, high-pedestrian trafficked areas and providing enhancements to multiple business districts**
- **Leverages and coordinates with other Village Business District infrastructure improvements and needs**
- **Could be prepared as a single-bid project, but could be constructed over a two-year time frame, avoiding holiday sales seasons**
- **Minimizes interruptions to on-street parking and traffic flow**
- **Avoids Illinois Department of Transportation (IDOT) rights-of-way, which would involve additional coordination and time**
- **Is cost effective, with a construction cost not to exceed \$5.5 million**
- **Includes a Demonstration Project for early completion, to showcase the Streetscape “palette” for community review**

The Committee’s deliberations focused the *Priority 1 Implementation Plan* on the East Elm Street, West Elm Street, and Hubbard Woods business districts. While the Committee desired to have an impact within each of the three business districts, it was decided that Indian Hill district streetscape improvements should wait for the completion of a planned IDOT reconfiguration of the Green Bay Road and Winnetka Avenue intersection. This placed Indian Hill streetscape improvements outside the Priority 1 time frame.



## Priority 1 Recommendations

For each of the first priority projects, a preliminary budget number has been developed to help understand the cost implications. A summary of each of the projects is included on the following pages, with a detailed cost break-down for each project located in Appendix A. The following Priority 1 Project Map helps illustrate each of the streetscape projects defined by the Committee. While numbers are used for organizational purposes, these numbers do not imply any order of sequencing or ranking of priority.

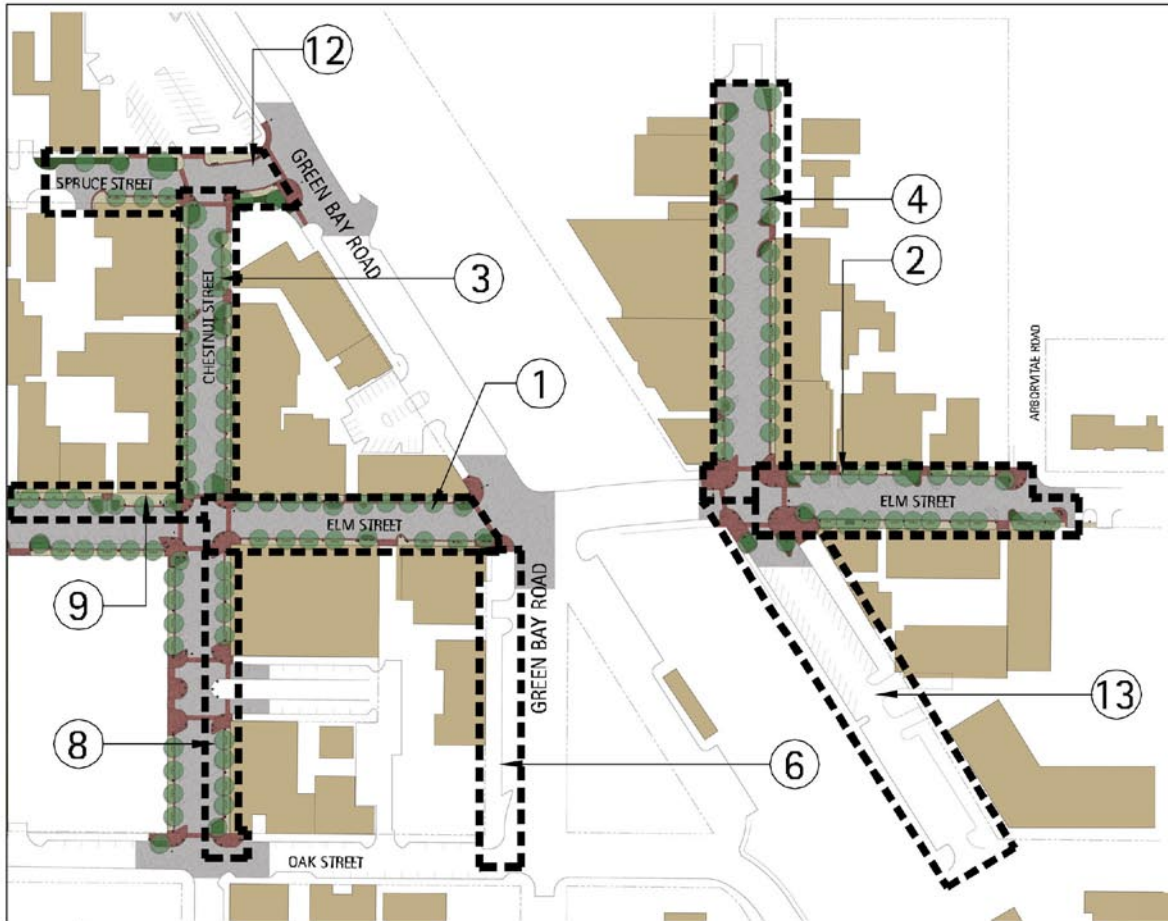

East/West Elm Street

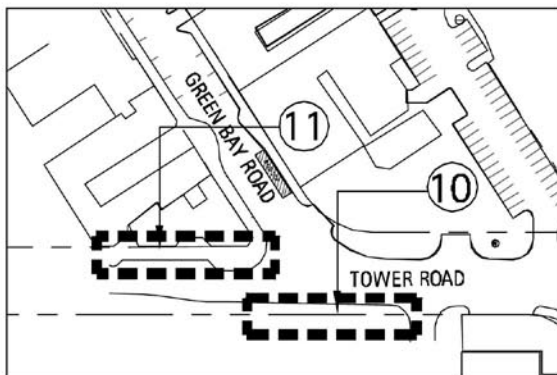

Hubbard Woods: Tower and Green Bay

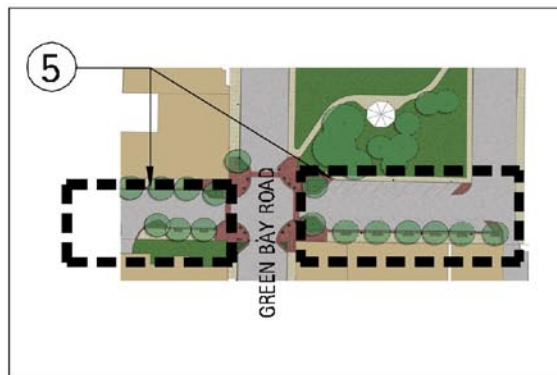

Hubbard Woods: Gage and Green Bay

## West Elm

---

1. Elm Street (both sides) - Chestnut to Green Bay:	\$509,350.00
3. Chestnut Street (both sides) - Elm to Spruce:	\$560,104.00
6. Green Bay Road (West side) - Elm to Oak:	\$135,703.00
8. Chestnut Street (East side) - Elm to Oak:	\$339,423.00
9. Elm Street (North side) - Church to Chestnut:	\$112,811.00
12: Spruce Street (both sides) - Rear of Talbots to Green Bay:	\$264,395.00

**West Elm Total:** **\$1,921,786.00**

---



## East Elm

---

2. Elm Street (both sides) - Lincoln to Arborvitae:	\$596,295.00
4. Lincoln Avenue (both sides) - Elm to Village Parking Lot:	\$691,955.00
13. Lincoln Avenue (both sides) - Elm to Oak:	\$498,042.00
<b>East Elm Total:</b>	<b>\$1,786,292.00</b>

---

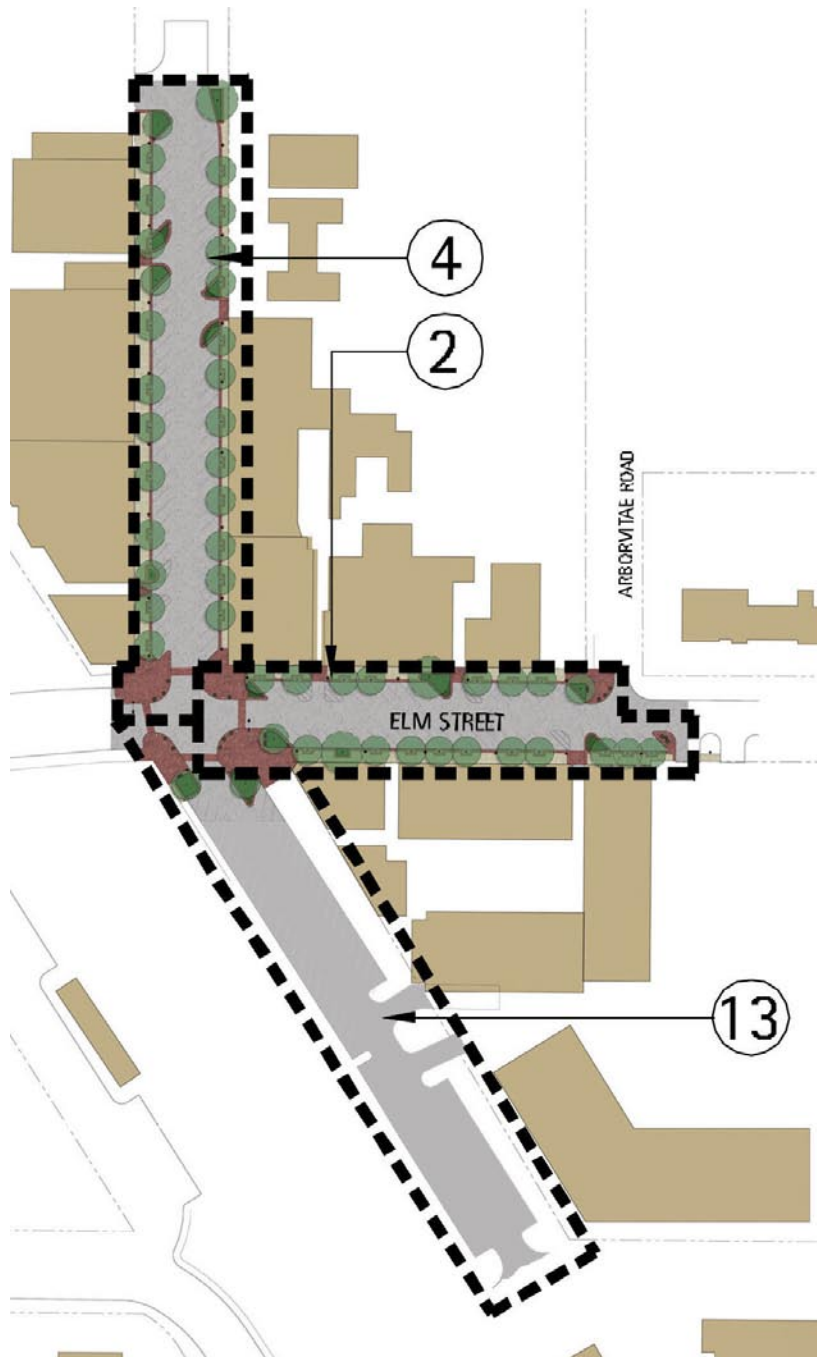

## Hubbard Woods

---

5A: Gage Street (both sides) - Green Bay west to Alley:	\$174,039.00
5B: Gage Street (both sides) - Green Bay east to Alley:	\$270,613.00
10: Demonstration Project:	<i>Completed</i>
11: Northwest Corner of Tower and Green Bay:	\$97,698.00
14: Hubbard Woods Movable Planters:	\$22,000.00
<b>Hubbard Woods Total:</b>	<b>\$564,350.00</b>

---

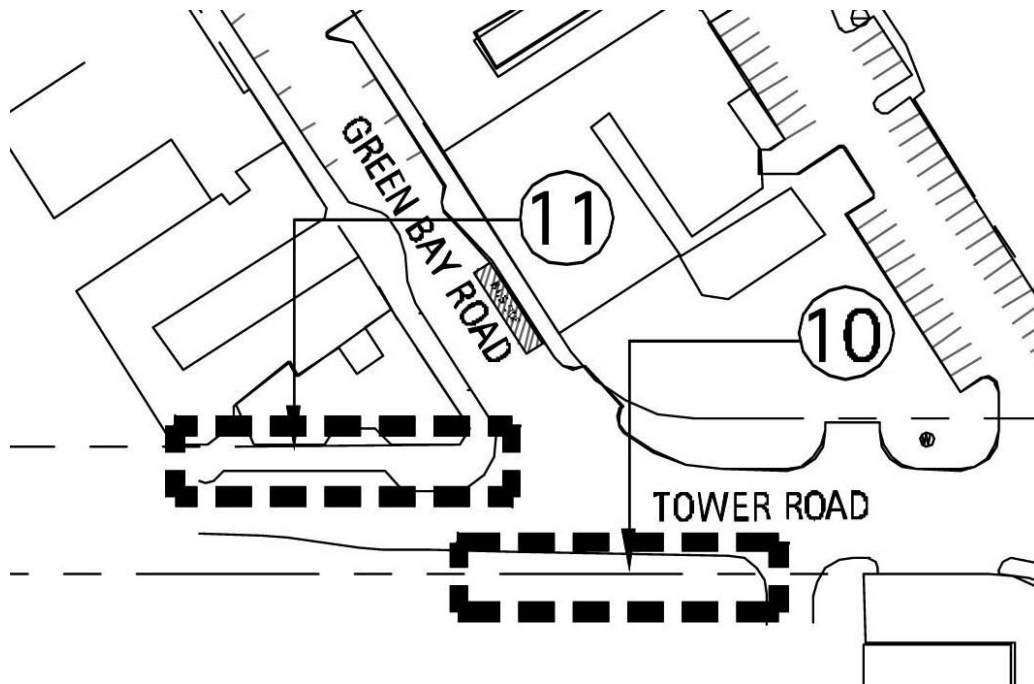
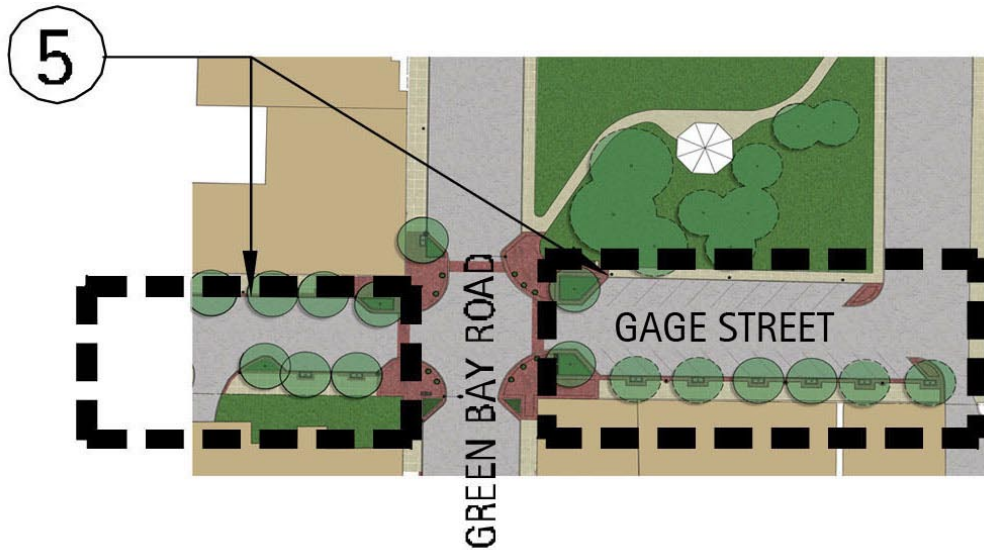

## Village Wide Signage Package

The costs for a Village Wide Signage Package identified in the Streetscape and Wayfinding Master Plan is included in the Priority 1 Projects. This signage package represents signage components not covered within the priority projects, also including those signs considered community gateways.

**Signage Package Total:** **\$310,000.00**

---

## Priority 1 Projects Total

For total budgeting purposes and as outlined in the Streetscape and Wayfinding Master Plan, a project budget contingency fee of 20% has been applied to the overall priority project totals. This fee includes all soft costs associated with the project, such as design and engineering fees, mobilization, as well as general construction cost contingencies.

<b>West Elm Total:</b>	<b>\$1,921,786.00</b>
<b>East Elm Total:</b>	<b>\$1,786,292.00</b>
<b>Hubbard Woods Total:</b>	<b>\$564,350.00</b>
<b>Signage Package Total:</b>	<b>\$310,000.00</b>

---

<b>Sub-total:</b>	<b>\$4,582,428.00</b>
<b>Project Contingency Fee:</b>	<b>\$916,485.60</b>
<b>PRIORITY 1 PROJECTS TOTAL:</b>	<b>5,498,913.60</b>

---

## Priority 1 Projects Alternate

Additionally, for priority projects 8 and 9 (Chestnut Street - Elm to Oak, and Elm Street - Church to Chestnut) an alternate reduced scope was studied where only pedestrian lighting would be installed, without any other streetscape amenities. This alternate scope would result in the following savings:

8: Chestnut Street (East side) - Elm to Oak (lights only):	-\$297,923.00
9: Elm Street (North side) - Church to Chestnut (lights only):	-\$94,811.00

---

Sub-total:	-\$392,734.00
Project Design Fees and Contingency:	-78,546.80
<b>PRIORITY 1 PROJECTS TOTAL:</b>	<b>\$5,027,632.80</b>

---

# Winnetka Streetscape - Cost Estimate

1 - Elm Street (Both Sides) Chestnut to Green Bay

October 2008

## SECTION 1: DEMOLITION

ITEM	QTY.	UNIT	COST	UNIT	TOTAL
<b>DEMOLITION</b>					
Saw Cut and Remove Asphalt	2,577	sf	\$ 2.00	sf	\$ 5,154.00
Existing Curb and Gutter	760	lf	\$ 11.50	lf	\$ 8,740.00
Existing Trees and Shrubs in Poor Condition	8	ea.	\$ 300.00	ea.	\$ 2,400.00
Existing Concrete Sidewalk	9,410	sf	\$ 3.50	sf	\$ 32,935.00
Existing Lights	3	ea.	\$ 1,500.00	ea.	\$ 4,500.00
Existing Tree Grates	14	ea.	\$ 250.00	ea.	\$ 3,500.00
Excess Soil Haul-Off	280	cy	\$ 25.00	cy	\$ 7,000.00
<b>Section 1: Demolition Sub-Total</b>					<b>\$64,229</b>

ITEM	QTY.	UNIT	COST	UNIT	TOTAL
<b>SECTION 2: SITE MATERIALS</b>					
<b>PAVING MATERIALS</b>					
Concrete Curb and Gutter	760	lf	\$ 35.00	lf	\$ 26,600.00
Clay Pavers on Concrete- Sidewalk	4,094	sf	\$ 20.00	lf	\$ 81,880.00
Concrete Walk	3,765	sf	\$ 9.00	sf	\$ 33,885.00
Asphalt Paving	2,577	sf	\$ 5.50	sf	\$ 14,173.50
Striping for Parking	136	lf	\$ 2.00	lf	\$ 272.00
Curbed Planter	180	lf	\$ 60.00	lf	\$ 10,800.00
Tree Grates	13	ea.	\$ 4,500.00	ea.	\$ 58,500.00
Pedestrian Lights	12	ea.	\$ 4,500.00	ea.	\$ 54,000.00
Intersection Cut-off Lights	2	ea.	\$ 10,000.00	ea.	\$ 20,000.00
Movable Planters	9	ea.	\$ 1,000.00	ea.	\$ 9,000.00
Benches	10	ea.	\$ 3,000.00	ea.	\$ 30,000.00
Trash Receptacle	4	ea.	\$ 1,500.00	ea.	\$ 6,000.00
Tactile Paving	48	sf	\$ 15.00	sf	\$ 720.00
Bike Racks	-	ea.	\$ 500.00	ea.	\$ -
Bollards	-	ea.	\$ 1,000.00	ea.	\$ -
<b>SITE WORK</b>					
Structural Soil	280	cy	\$ 125.00	cy	\$ 35,000.00
Planting Soil	32	cy	\$ 50.00	cy	\$ 1,600.00
Drainage	1,100	lf	\$ 9.00	lf	\$ 9,900.00
Irrigation	1	ls	\$ 15,000.00	ls	\$ 15,000.00
Electric at Tree Grates	13	ea.	\$ 350.00	ea.	\$ 4,550.00
Storm Lateral Connection - Two per Block	2	ea.	\$ 250.00	ea.	\$ 500.00
<b>Section 2: Site Materials Sub-Total</b>					<b>\$412,381</b>

ITEM	QTY.	UNIT	COST	UNIT	TOTAL
<b>SECTION 3: SOFTSCAPE</b>					
Shredded Hardwood Mulch	3	cy	\$ 60.00	cy	\$ 180.00
Gravel in Tree Grates	2	cy	\$ 80.00	cy	\$ 160.00
Shade Trees	4	ea.	\$ 750.00	ea.	\$ 3,000.00
Additional Plant Material (shrubs/perennials/annuals)	1	ls	\$ 10,000.00	ls	\$ 10,000.00
<b>Section 3: Softscape Sub-Total</b>					<b>\$13,340</b>

ITEM	QTY.	UNIT	COST	UNIT	TOTAL
<b>SECTION 4: SIGNAGE</b>					
Kiosk	1	ea.	\$ 15,000.00	ea.	\$ 15,000.00
District Gateway	-	ea.	\$ 15,000.00	ea.	\$ -
Parking Directional	-	ea.	\$ 2,500.00	ea.	\$ -
Parking Identity	-	ea.	\$ 2,500.00	ea.	\$ -
Regulatory Sign on Decorative Pole	2	ea.	\$ 1,100.00	ea.	\$ 2,200.00
Street Sign on Decorative Pole	2	ea.	\$ 1,100.00	ea.	\$ 2,200.00
<b>Section 3: Softscape Sub-Total</b>					<b>\$19,400</b>

<b>PROJECT SUBTOTAL</b>	<b>\$509,350</b>
<b>Project Fees + Contingency @ 20%</b>	<b>\$101,870</b>
<b>PROJECT TOTAL</b>	<b>\$611,219</b>

Source: THE LAKOTA GROUP

# Winnetka Streetscape - Cost Estimate

2 - Elm Street Lincoln to Arborvitae

October 2008

## SECTION 1: DEMOLITION

ITEM	QTY.	UNIT	COST	UNIT	TOTAL
<b>DEMOLITION</b>					
Saw Cut and Remove Asphalt	2,685	sf	\$ 2.00	sf	\$ 5,370.00
Existing Curb and Gutter	895	lf	\$ 11.50	lf	\$ 10,292.50
Existing Trees and Shrubs in Poor Condition	10	ea.	\$ 300.00	ea.	\$ 3,000.00
Existing Concrete Sidewalk	9,980	sf	\$ 3.50	sf	\$ 34,930.00
Existing Lights	5	ea.	\$ 1,500.00	ea.	\$ 7,500.00
Existing Tree Grates	14	ea.	\$ 250.00	ea.	\$ 3,500.00
Excess Soil Haul-Off	267	cy	\$ 25.00	cy	\$ 6,675.00
<b>Section 1: Demolition Sub-Total</b>					<b>\$71,268</b>

## SECTION 2: SITE MATERIALS

ITEM	QTY.	UNIT	COST	UNIT	TOTAL
<b>PAVING MATERIALS</b>					
Concrete Curb and Gutter	895	lf	\$ 35.00	lf	\$ 31,325.00
Clay Pavers on Concrete- Sidewalk	5,910	sf	\$ 20.00	lf	\$ 118,200.00
Concrete Walk	4,860	sf	\$ 9.00	sf	\$ 43,740.00
Asphalt Paving	2,685	sf	\$ 5.50	sf	\$ 14,767.50
Striping for Parking	1,440	lf	\$ 2.00	lf	\$ 2,880.00
Curbed Planter	278	lf	\$ 60.00	lf	\$ 16,680.00
Tree Grates	17	ea.	\$ 4,500.00	ea.	\$ 76,500.00
Pedestrian Lights	11	ea.	\$ 4,500.00	ea.	\$ 49,500.00
Intersection Cut-off Lights	1	ea.	\$ 10,000.00	ea.	\$ 10,000.00
Movable Planters	12	ea.	\$ 1,000.00	ea.	\$ 12,000.00
Benches	5	ea.	\$ 3,000.00	ea.	\$ 15,000.00
Trash Receptacle	4	ea.	\$ 1,500.00	ea.	\$ 6,000.00
Tactile Paving	120	sf	\$ 15.00	sf	\$ 1,800.00
Bike Racks	-	ea.	\$ 500.00	ea.	\$ -
Bollards	-	ea.	\$ 1,000.00	ea.	\$ -
<b>SITE WORK</b>					
Structural Soil	267	cy	\$ 125.00	cy	\$ 33,375.00
Planting Soil	46	cy	\$ 50.00	cy	\$ 2,300.00
Drainage	900	lf	\$ 9.00	lf	\$ 8,100.00
Irrigation	1	ls	\$ 20,000.00	ls	\$ 20,000.00
Electric at Tree Grates	9	ea.	\$ 350.00	ea.	\$ 3,150.00
Storm Lateral Connection - Two per Block	4	ea.	\$ 250.00	ea.	\$ 1,000.00
<b>Section 2: Site Materials Sub-Total</b>					<b>\$466,318</b>

## SECTION 3: SOFTSCAPE

ITEM	QTY.	UNIT	COST	UNIT	TOTAL
Shredded Hardwood Mulch	7	cy	\$ 60.00	cy	\$ 420.00
Gravel in Tree Grates	3	cy	\$ 80.00	cy	\$ 240.00
Shade Trees	9	ea.	\$ 750.00	ea.	\$ 6,750.00
Additional Plant Material (shrubs/perennials/annuals)	1	ls	\$ 10,000.00	ls	\$ 10,000.00
<b>Section 3: Softscape Sub-Total</b>					<b>\$17,410</b>

## SECTION 4: SIGNAGE

ITEM	QTY.	UNIT	COST	UNIT	TOTAL
Kiosk	1	ea.	\$ 15,000.00	ea.	\$ 15,000.00
District Gateway	1	ea.	\$ 15,000.00	ea.	\$ 15,000.00
Parking Directional	1	ea.	\$ 2,500.00	ea.	\$ 2,500.00
Parking Identity	-	ea.	\$ 2,500.00	ea.	\$ -
Regulatory Sign on Decorative Pole	5	ea.	\$ 1,100.00	ea.	\$ 5,500.00
Street Sign on Decorative Pole	3	ea.	\$ 1,100.00	ea.	\$ 3,300.00
<b>Section 3: Softscape Sub-Total</b>					<b>\$41,300</b>

## PROJECT SUBTOTAL

\$596,295

Project Fees + Contingency @ 20%

\$119,259

## PROJECT TOTAL

\$715,554

Source: THE LAKOTA GROUP

**Winnetka Streetscape****3 - Chestnut (Both Sides) Elm to Spruce****October 2008****SECTION 1: DEMOLITION**

ITEM	QTY.	UNIT	COST	UNIT	TOTAL
<b>DEMOLITION</b>					
Saw Cut and Remove Asphalt	2,943	sf	\$ 2.00	sf	\$ 5,886.00
Existing Curb and Gutter	1,012	lf	\$ 11.50	lf	\$ 11,638.00
Existing Trees and Shrubs in Poor Condition	17	ea.	\$ 300.00	ea.	\$ 5,100.00
Existing Concrete Sidewalk	6,688	sf	\$ 3.50	sf	\$ 23,408.00
Existing Lights	3	ea.	\$ 1,500.00	ea.	\$ 4,500.00
Existing Tree Grates	22	ea.	\$ 250.00	ea.	\$ 5,500.00
Excess Soil Haul-Off	370	cy	\$ 25.00	cy	\$ 9,250.00
<b>Section 1: Demolition Sub-Total</b>					<b>\$65,282</b>

**SECTION 2: SITE MATERIALS**

ITEM	QTY.	UNIT	COST	UNIT	TOTAL
<b>PAVING MATERIALS</b>					
Concrete Curb and Gutter	1,012	lf	\$ 35.00	lf	\$ 35,420.00
Clay Pavers on Concrete- Sidewalk	3,015	sf	\$ 20.00	lf	\$ 60,300.00
Concrete Walk	4,385	sf	\$ 9.00	sf	\$ 39,465.00
Asphalt Paving	2,943	sf	\$ 5.50	sf	\$ 16,186.50
Striping for Parking	565	lf	\$ 2.00	lf	\$ 1,130.00
Curbed Planter	350	lf	\$ 60.00	lf	\$ 21,000.00
Tree Grates	18	ea.	\$ 4,500.00	ea.	\$ 81,000.00
Pedestrian Lights	13	ea.	\$ 4,500.00	ea.	\$ 58,500.00
Intersection Cut-off Lights	1	ea.	\$ 10,000.00	ea.	\$ 10,000.00
Movable Planters	10	ea.	\$ 1,000.00	ea.	\$ 10,000.00
Benches	3	ea.	\$ 3,000.00	ea.	\$ 9,000.00
Trash Receptacle	7	ea.	\$ 1,500.00	ea.	\$ 10,500.00
Tactile Paving	84	sf	\$ 15.00	sf	\$ 1,260.00
Bike Racks	-	ea.	\$ 500.00	ea.	\$ -
Bollards	4	ea.	\$ 1,000.00	ea.	\$ 4,000.00
<b>SITE WORK</b>					
Structural Soil	366	cy	\$ 125.00	cy	\$ 45,750.00
Planting Soil	110	cy	\$ 50.00	cy	\$ 5,500.00
Drainage	1,250	lf	\$ 9.00	lf	\$ 11,250.00
Irrigation	1	ls	\$ 20,000.00	ls	\$ 20,000.00
Electric at Tree Grates	7	ea.	\$ 350.00	ea.	\$ 2,450.00
Storm Lateral Connection - Two per Block	2	ea.	\$ 250.00	ea.	\$ 500.00
<b>Section 2: Site Materials Sub-Total</b>					<b>\$443,212</b>

**SECTION 3: SOFTSCAPE**

ITEM	QTY.	UNIT	COST	UNIT	TOTAL
Shredded Hardwood Mulch	10	cy	\$ 60.00	cy	\$ 600.00
Gravel in Tree Grates	2	cy	\$ 80.00	cy	\$ 160.00
Shade Trees	19	ea.	\$ 750.00	ea.	\$ 14,250.00
Additional Plant Material (shrubs/perennials/annuals)	1	ls	\$ 15,000.00	ls	\$ 15,000.00
<b>Section 3: Softscape Sub-Total</b>					<b>\$30,010</b>

**SECTION 4: SIGNAGE**

ITEM	QTY.	UNIT	COST	UNIT	TOTAL
Kiosk	-	ea.	\$ 15,000.00	ea.	\$ -
District Gateway	1	ea.	\$ 15,000.00	ea.	\$ 15,000.00
Parking Directional	-	ea.	\$ 2,500.00	ea.	\$ -
Parking Identity	-	ea.	\$ 2,500.00	ea.	\$ -
Regulatory Sign on Decorative Pole	4	ea.	\$ 1,100.00	ea.	\$ 4,400.00
Street Sign on Decorative Pole	2	ea.	\$ 1,100.00	ea.	\$ 2,200.00
<b>Section 3: Softscape Sub-Total</b>					<b>\$21,600</b>

<b>PROJECT SUBTOTAL</b>	<b>\$560,104</b>
<b>Project Fees + Contingency @ 20%</b>	<b>\$112,021</b>
<b>PROJECT TOTAL</b>	<b>\$672,124</b>

Source: THE LAKOTA GROUP

# Winnetka Streetscape - Cost Estimate

4 - Lincoln Avenue (Both Sides) Elm to Village Parking Lot

October 2008

## SECTION 1: DEMOLITION

ITEM	QTY.	UNIT	COST	UNIT	TOTAL
<b>DEMOLITION</b>					
Saw Cut and Remove Asphalt	3,600	sf	\$ 2.00	sf	\$ 7,200.00
Existing Curb and Gutter	1,200	lf	\$ 11.50	lf	\$ 13,800.00
Existing Trees and Shrubs in Poor Condition	10	ea.	\$ 300.00	ea.	\$ 3,000.00
Existing Concrete Sidewalk	12,280	sf	\$ 3.50	sf	\$ 42,980.00
Existing Lights	5	ea.	\$ 1,500.00	ea.	\$ 7,500.00
Existing Tree Grates	22	ea.	\$ 250.00	ea.	\$ 5,500.00
Excess Soil Haul-Off	560	cy	\$ 25.00	cy	\$ 14,000.00
<b>Section 1: Demolition Sub-Total</b>					<b>\$93,980</b>

## SECTION 2: SITE MATERIALS

ITEM	QTY.	UNIT	COST	UNIT	TOTAL
<b>PAVING MATERIALS</b>					
Concrete Curb and Gutter	1,200	lf	\$ 35.00	lf	\$ 42,000.00
Clay Pavers on Concrete- Sidewalk	4,760	sf	\$ 20.00	lf	\$ 95,200.00
Concrete Walk	7,520	sf	\$ 9.00	sf	\$ 67,680.00
Asphalt Paving	3,600	sf	\$ 5.50	sf	\$ 19,800.00
Striping for Parking	1,380	lf	\$ 2.00	lf	\$ 2,760.00
Curbed Planter	360	lf	\$ 60.00	lf	\$ 21,600.00
Tree Grates	22	ea.	\$ 4,500.00	ea.	\$ 99,000.00
Pedestrian Lights	16	ea.	\$ 4,500.00	ea.	\$ 72,000.00
Intersection Cut-off Lights	1	ea.	\$ 10,000.00	ea.	\$ 10,000.00
Movable Planters	3	ea.	\$ 1,000.00	ea.	\$ 3,000.00
Benches	-	ea.	\$ 3,000.00	ea.	\$ -
Trash Receptacle	6	ea.	\$ 1,500.00	ea.	\$ 9,000.00
Tactile Paving	72	sf	\$ 15.00	sf	\$ 1,080.00
Bike Racks	-	ea.	\$ 500.00	ea.	\$ -
Bollards	-	ea.	\$ 1,000.00	ea.	\$ -
<b>SITE WORK</b>					
Structural Soil	555	cy	\$ 125.00	cy	\$ 69,375.00
Planting Soil	100	cy	\$ 50.00	cy	\$ 5,000.00
Drainage	1,600	lf	\$ 9.00	lf	\$ 14,400.00
Irrigation	1	ls	\$ 25,000.00	ls	\$ 25,000.00
Electric at Tree Grates	22	ea.	\$ 350.00	ea.	\$ 7,700.00
Storm Lateral Connection - Two per Block	2	ea.	\$ 250.00	ea.	\$ 500.00
<b>Section 2: Site Materials Sub-Total</b>					<b>\$565,095</b>

## SECTION 3: SOFTSCAPE

ITEM	QTY.	UNIT	COST	UNIT	TOTAL
Shredded Hardwood Mulch	9	cy	\$ 60.00	cy	\$ 540.00
Gravel in Tree Grates	3	cy	\$ 80.00	cy	\$ 240.00
Shade Trees	4	ea.	\$ 750.00	ea.	\$ 3,000.00
Additional Plant Material (shrubs/perennials/annuals)	1	ls	\$ 15,000.00	ls	\$ 15,000.00
<b>Section 3: Softscape Sub-Total</b>					<b>\$18,780</b>

## SECTION 4: SIGNAGE

ITEM	QTY.	UNIT	COST	UNIT	TOTAL
Kiosk	-	ea.	\$ 15,000.00	ea.	\$ -
District Gateway	-	ea.	\$ 15,000.00	ea.	\$ -
Parking Directional	2	ea.	\$ 2,500.00	ea.	\$ 5,000.00
Parking Identity	1	ea.	\$ 2,500.00	ea.	\$ 2,500.00
Regulatory Sign on Decorative Pole	4	ea.	\$ 1,100.00	ea.	\$ 4,400.00
Street Sign on Decorative Pole	2	ea.	\$ 1,100.00	ea.	\$ 2,200.00
<b>Section 3: Softscape Sub-Total</b>					<b>\$14,100</b>

<b>PROJECT SUBTOTAL</b>	<b>\$691,955</b>
<b>Project Fees + Contingency @ 20%</b>	<b>\$138,391</b>
<b>PROJECT TOTAL</b>	<b>\$830,346</b>

Source: THE LAKOTA GROUP

# Winnetka Streetscape - Cost Estimate

5A - Gage Lane - West of Green Bay

October 2008

## SECTION 1: DEMOLITION

ITEM	QTY.	UNIT	COST	UNIT	TOTAL
<b>DEMOLITION</b>					
Saw Cut and Remove Asphalt	870	sf	\$ 2.00	sf	\$ 1,740.00
Existing Curb and Gutter	290	lf	\$ 11.50	lf	\$ 3,335.00
Existing Trees and Shrubs in Poor Condition	3	ea.	\$ 300.00	ea.	\$ 900.00
Existing Concrete Sidewalk	2,795	sf	\$ 3.50	sf	\$ 9,782.50
Existing Lights	1	ea.	\$ 1,500.00	ea.	\$ 1,500.00
Existing Tree Grates	3	ea.	\$ 250.00	ea.	\$ 750.00
Excess Soil Haul-Off	100	cy	\$ 25.00	cy	\$ 2,500.00
<b>Section 1: Demolition Sub-Total</b>					<b>\$20,508</b>

## SECTION 2: SITE MATERIALS

ITEM	QTY.	UNIT	COST	UNIT	TOTAL
<b>PAVING MATERIALS</b>					
Concrete Curb and Gutter	290	lf	\$ 35.00	lf	\$ 10,150.00
Clay Pavers on Concrete- Sidewalk	780	sf	\$ 20.00	lf	\$ 15,600.00
Concrete Walk	2,015	sf	\$ 9.00	sf	\$ 18,135.00
Asphalt Paving	870	sf	\$ 5.50	sf	\$ 4,785.00
Striping for Parking	48	lf	\$ 2.00	lf	\$ 96.00
Curbed Planter	106	lf	\$ 60.00	lf	\$ 6,360.00
Tree Grates	6	ea.	\$ 4,500.00	ea.	\$ 27,000.00
Pedestrian Lights	5	ea.	\$ 4,500.00	ea.	\$ 22,500.00
Intersection Cut-off Lights	-	ea.	\$ 10,000.00	ea.	\$ -
Movable Planters	-	ea.	\$ 1,000.00	ea.	\$ -
Benches	-	ea.	\$ 3,000.00	ea.	\$ -
Trash Receptacle	2	ea.	\$ 1,500.00	ea.	\$ 3,000.00
Tactile Paving	16	sf	\$ 15.00	sf	\$ 240.00
Bike Racks	-	ea.	\$ 500.00	ea.	\$ -
Bollards	-	ea.	\$ 1,000.00	ea.	\$ -
<b>SITE WORK</b>					
Structural Soil	153	cy	\$ 125.00	cy	\$ 19,125.00
Planting Soil	18	cy	\$ 50.00	cy	\$ 900.00
Drainage	320	lf	\$ 9.00	lf	\$ 2,880.00
Irrigation	1	ls	\$ 5,000.00	ls	\$ 5,000.00
Electric at Tree Grates	6	ea.	\$ 350.00	ea.	\$ 2,100.00
Storm Lateral Connection - Two per Block	1	ea.	\$ 250.00	ea.	\$ 250.00
<b>Section 2: Site Materials Sub-Total</b>					<b>\$138,121</b>

## SECTION 3: SOFTSCAPE

ITEM	QTY.	UNIT	COST	UNIT	TOTAL
Shredded Hardwood Mulch	2	cy	\$ 60.00	cy	\$ 120.00
Gravel in Tree Grates	3	cy	\$ 80.00	cy	\$ 240.00
Shade Trees	9	ea.	\$ 750.00	ea.	\$ 6,750.00
Additional Plant Material (shrubs/perennials/annuals)	1	ls	\$ 5,000.00	ls	\$ 5,000.00
<b>Section 3: Softscape Sub-Total</b>					<b>\$12,110</b>

## SECTION 4: SIGNAGE

ITEM	QTY.	UNIT	COST	UNIT	TOTAL
Kiosk	-	ea.	\$ 15,000.00	ea.	\$ -
District Gateway	-	ea.	\$ 15,000.00	ea.	\$ -
Parking Directional	-	ea.	\$ 2,500.00	ea.	\$ -
Parking Identity	-	ea.	\$ 2,500.00	ea.	\$ -
Regulatory Sign on Decorative Pole	2	ea.	\$ 1,100.00	ea.	\$ 2,200.00
Street Sign on Decorative Pole	1	ea.	\$ 1,100.00	ea.	\$ 1,100.00
<b>Section 3: Softscape Sub-Total</b>					<b>\$3,300</b>

## PROJECT SUBTOTAL

\$174,039

Project Fees + Contingency @ 20%

\$34,808

## PROJECT TOTAL

\$208,846

Source: THE LAKOTA GROUP

# Winnetka Streetscape - Cost Estimate

5B - Gage Lane - East of Green Bay

October 2008

## SECTION 1: DEMOLITION

ITEM	QTY.	UNIT	COST	UNIT	TOTAL
<b>DEMOLITION</b>					
Saw Cut and Remove Asphalt	537	sf	\$ 2.00	sf	\$ 1,074.00
Existing Curb and Gutter	179	lf	\$ 11.50	lf	\$ 2,058.50
Existing Trees and Shrubs in Poor Condition	1	ea.	\$ 300.00	ea.	\$ 300.00
Existing Concrete Sidewalk	4,026	sf	\$ 3.50	sf	\$ 14,091.00
Existing Lights	3	ea.	\$ 1,500.00	ea.	\$ 4,500.00
Existing Tree Grates	1	ea.	\$ 250.00	ea.	\$ 250.00
Excess Soil Haul-Off	180	cy	\$ 25.00	cy	\$ 4,500.00
<b>Section 1: Demolition Sub-Total</b>					<b>\$26,774</b>

## SECTION 2: SITE MATERIALS

ITEM	QTY.	UNIT	COST	UNIT	TOTAL
<b>PAVING MATERIALS</b>					
Concrete Curb and Gutter	179	lf	\$ 35.00	lf	\$ 6,265.00
Clay Pavers on Concrete- Sidewalk	2,630	sf	\$ 20.00	lf	\$ 52,600.00
Concrete Walk	1,396	sf	\$ 9.00	sf	\$ 12,564.00
Asphalt Paving	1,530	sf	\$ 5.50	sf	\$ 8,415.00
Striping for Parking	270	lf	\$ 2.00	lf	\$ 540.00
Curbed Planter	150	lf	\$ 60.00	lf	\$ 9,000.00
Tree Grates	6	ea.	\$ 4,500.00	ea.	\$ 27,000.00
Pedestrian Lights	8	ea.	\$ 4,500.00	ea.	\$ 36,000.00
Intersection Cut-off Lights	-	ea.	\$ 10,000.00	ea.	\$ -
Movable Planters	-	ea.	\$ 1,000.00	ea.	\$ -
Benches	4	ea.	\$ 3,000.00	ea.	\$ 12,000.00
Trash Receptacle	-	ea.	\$ 1,500.00	ea.	\$ -
Tactile Paving	20	sf	\$ 15.00	sf	\$ 300.00
Bike Racks	-	ea.	\$ 500.00	ea.	\$ -
Bollards	-	ea.	\$ 1,000.00	ea.	\$ -
<b>SITE WORK</b>					
Structural Soil	180	cy	\$ 125.00	cy	\$ 22,500.00
Planting Soil	12	cy	\$ 50.00	cy	\$ 600.00
Drainage	175	lf	\$ 9.00	lf	\$ 1,575.00
Irrigation	1	ls	\$ 12,000.00	ls	\$ 12,000.00
Electric at Tree Grates	6	ea.	\$ 350.00	ea.	\$ 2,100.00
Storm Lateral Connection - Two per Block	2	ea.	\$ 250.00	ea.	\$ 500.00
<b>Section 2: Site Materials Sub-Total</b>					<b>\$203,959</b>

## SECTION 3: SOFTSCAPE

ITEM	QTY.	UNIT	COST	UNIT	TOTAL
Shredded Hardwood Mulch	2	cy	\$ 60.00	cy	\$ 120.00
Gravel in Tree Grates	2	cy	\$ 80.00	cy	\$ 160.00
Shade Trees	8	ea.	\$ 750.00	ea.	\$ 6,000.00
Additional Plant Material (shrubs/perennials/annuals)	1	ls	\$ 12,000.00	ls	\$ 12,000.00
<b>Section 3: Softscape Sub-Total</b>					<b>\$18,280</b>

## SECTION 4: SIGNAGE

ITEM	QTY.	UNIT	COST	UNIT	TOTAL
Kiosk	-	ea.	\$ 15,000.00	ea.	\$ -
District Gateway	1	ea.	\$ 15,000.00	ea.	\$ 15,000.00
Parking Directional	-	ea.	\$ 2,500.00	ea.	\$ -
Parking Identity	-	ea.	\$ 2,500.00	ea.	\$ -
Regulatory Sign on Decorative Pole	4	ea.	\$ 1,100.00	ea.	\$ 4,400.00
Street Sign on Decorative Pole	2	ea.	\$ 1,100.00	ea.	\$ 2,200.00
<b>Section 3: Softscape Sub-Total</b>					<b>\$21,600</b>

<b>PROJECT SUBTOTAL</b>	<b>\$270,613</b>
<b>Project Fees + Contingency @ 20%</b>	<b>\$54,123</b>
<b>PROJECT TOTAL</b>	<b>\$324,735</b>

Source: THE LAKOTA GROUP

# Winnetka Streetscape - Cost Estimate

6 - Green Bay (West Side) Oak Street to Elm Street

October 2008

## SECTION 1: DEMOLITION

ITEM	QTY.	UNIT	COST	UNIT	TOTAL
<b>DEMOLITION</b>					
Saw Cut and Remove Asphalt	1,150	sf	\$ 2.00	sf	\$ 2,300.00
Existing Curb and Gutter	385	lf	\$ 11.50	lf	\$ 4,427.50
Existing Trees and Shrubs in Poor Condition	-	ea.	\$ 300.00	ea.	\$ -
Existing Concrete Sidewalk	3,850	sf	\$ 3.50	sf	\$ 13,475.00
Existing Lights	2	ea.	\$ 1,500.00	ea.	\$ 3,000.00
Existing Tree Grates	-	ea.	\$ 250.00	ea.	\$ -
Excess Soil Haul-Off	-	cy	\$ 25.00	cy	\$ -
<b>Section 1: Demolition Sub-Total</b>					<b>\$23,203</b>

## SECTION 2: SITE MATERIALS

ITEM	QTY.	UNIT	COST	UNIT	TOTAL
<b>PAVING MATERIALS</b>					
Concrete Curb and Gutter	385	lf	\$ 35.00	lf	\$ 13,475.00
Clay Pavers on Concrete- Sidewalk	-	sf	\$ 20.00	lf	\$ -
Concrete Walk	3,850	sf	\$ 9.00	sf	\$ 34,650.00
Asphalt Paving	1,150	sf	\$ 5.50	sf	\$ 6,325.00
Striping for Parking	400	lf	\$ 2.00	lf	\$ 800.00
Curbed Planter	-	lf	\$ 60.00	lf	\$ -
Tree Grates	-	ea.	\$ 4,500.00	ea.	\$ -
Pedestrian Lights	7	ea.	\$ 4,500.00	ea.	\$ 31,500.00
Intersection Cut-off Lights	1	ea.	\$ 10,000.00	ea.	\$ 10,000.00
Movable Planters	8	ea.	\$ 1,000.00	ea.	\$ 8,000.00
Benches	2	ea.	\$ 3,000.00	ea.	\$ 6,000.00
Trash Receptacle	1	ea.	\$ 1,500.00	ea.	\$ 1,500.00
Tactile Paving	-	sf	\$ 15.00	sf	\$ -
Bike Racks	-	ea.	\$ 500.00	ea.	\$ -
Bollards	-	ea.	\$ 1,000.00	ea.	\$ -
<b>SITE WORK</b>					
Structural Soil	-	cy	\$ 125.00	cy	\$ -
Planting Soil	-	cy	\$ 50.00	cy	\$ -
Drainage	-	lf	\$ 9.00	lf	\$ -
Irrigation	-	ls	\$ 20,000.00	ls	\$ -
Electric at Tree Grates	-	ea.	\$ 350.00	ea.	\$ -
Storm Lateral Connection - Two per Block	1	ea.	\$ 250.00	ea.	\$ 250.00
<b>Section 2: Site Materials Sub-Total</b>					<b>\$112,500</b>

## SECTION 3: SOFTSCAPE

ITEM	QTY.	UNIT	COST	UNIT	TOTAL
Shredded Hardwood Mulch	-	cy	\$ 60.00	cy	\$ -
Gravel in Tree Grates	-	cy	\$ 80.00	cy	\$ -
Shade Trees	-	ea.	\$ 750.00	ea.	\$ -
Additional Plant Material (shrubs/perennials/annuals)	-	ls	\$ -	ls	\$ -
<b>Section 3: Softscape Sub-Total</b>					<b>\$0</b>

## SECTION 4: SIGNAGE

ITEM	QTY.	UNIT	COST	UNIT	TOTAL
Kiosk	-	ea.	\$ 15,000.00	ea.	\$ -
District Gateway	-	ea.	\$ 15,000.00	ea.	\$ -
Parking Directional	-	ea.	\$ 2,500.00	ea.	\$ -
Parking Identity	-	ea.	\$ 2,500.00	ea.	\$ -
Regulatory Sign on Decorative Pole	-	ea.	\$ 1,100.00	ea.	\$ -
Street Sign on Decorative Pole	-	ea.	\$ 1,100.00	ea.	\$ -
<b>Section 3: Softscape Sub-Total</b>					<b>\$0</b>

<b>PROJECT SUBTOTAL</b>	<b>\$135,703</b>
Project Fees + Contingency @ 20%	\$27,141
<b>PROJECT TOTAL</b>	<b>\$162,843</b>

Source: THE LAKOTA GROUP

# Winnetka Streetscape – Cost Estimate

7 – Total Signage Package

October 2008

## VILLAGE CONTEXT SIGNAGE

ITEM	QTY.	UNIT	COST	UNIT	TOTAL
Major Village Identity	2	ea.	\$ 35,000.00	ea.	\$ 70,000.00
Minor Village Identity	6	ea.	\$ 25,000.00	ea.	\$ 150,000.00
District Directional	9	ea.	\$ 2,500.00	ea.	\$ 22,500.00
<b>Village Context Signage Sub-Total</b>					<b>\$242,500</b>

## WEST/EAST ELM SIGNAGE

ITEM	QTY.	UNIT	COST	UNIT	TOTAL
Major Village Identity	-	ea.	\$ 35,000.00	ea.	\$ -
Minor Village Identity	-	ea.	\$ 25,000.00	ea.	\$ -
Community Events Kiosk	1	ea.	\$ 35,000.00	ea.	\$ 35,000.00
Business Kiosk	2	ea.	\$ 15,000.00	ea.	\$ 30,000.00
District Gateway	1	ea.	\$ 15,000.00	ea.	\$ 15,000.00
District Directional	2	ea.	\$ 2,500.00	ea.	\$ 5,000.00
Parking Directional	9	ea.	\$ 2,500.00	ea.	\$ 22,500.00
Parking Identity	5	ea.	\$ 2,500.00	ea.	\$ 12,500.00
Regulatory Sign on Decorative Pole	-	ea.	\$ 1,100.00	ea.	\$ -
Street Sign on Decorative Pole	-	ea.	\$ 1,100.00	ea.	\$ -
<b>East/West Elm Signage Sub-Total</b>					<b>\$120,000</b>

## HUBBARD WOODS SIGNAGE

ITEM	QTY.	UNIT	COST	UNIT	TOTAL
Major Village Identity	-	ea.	\$ 35,000.00	ea.	\$ -
Minor Village Identity	-	ea.	\$ 25,000.00	ea.	\$ -
Community Events Kiosk	1	ea.	\$ 35,000.00	ea.	\$ 35,000.00
Business Kiosk	1	ea.	\$ 15,000.00	ea.	\$ 15,000.00
District Gateway	2	ea.	\$ 15,000.00	ea.	\$ 30,000.00
District Directional	1	ea.	\$ 2,500.00	ea.	\$ 2,500.00
Parking Directional	6	ea.	\$ 2,500.00	ea.	\$ 15,000.00
Parking Identity	3	ea.	\$ 2,500.00	ea.	\$ 7,500.00
Regulatory Sign on Decorative Pole	-	ea.	\$ 1,100.00	ea.	\$ -
Street Sign on Decorative Pole	-	ea.	\$ 1,100.00	ea.	\$ -
<b>Hubbard Woods Signage Sub-Total</b>					<b>\$105,000</b>

## INDIAN HILL SIGNAGE

ITEM	QTY.	UNIT	COST	UNIT	TOTAL
Major Village Identity	-	ea.	\$ 35,000.00	ea.	\$ -
Minor Village Identity	-	ea.	\$ 25,000.00	ea.	\$ -
Community Events Kiosk	1	ea.	\$ 35,000.00	ea.	\$ 35,000.00
Business Kiosk	-	ea.	\$ 15,000.00	ea.	\$ -
District Gateway	3	ea.	\$ 15,000.00	ea.	\$ 45,000.00
District Directional	-	ea.	\$ 2,500.00	ea.	\$ -
Parking Directional	2	ea.	\$ 2,500.00	ea.	\$ 5,000.00
Parking Identity	-	ea.	\$ 2,500.00	ea.	\$ -
Regulatory Sign on Decorative Pole	-	ea.	\$ 1,100.00	ea.	\$ -
Street Sign on Decorative Pole	-	ea.	\$ 1,100.00	ea.	\$ -
<b>Indian Hill Signage Sub-Total</b>					<b>\$85,000</b>

## PROJECT SUBTOTAL

**\$310,000**

Project Fees + Contingency @ 20%

**\$62,000**

## PROJECT TOTAL

**\$372,000**

Source: THE LAKOTA GROUP

# Winnetka Streetscape - Cost Estimates

8A - Chestnut (East Side) - Elm to Oak - Lights Only

October 2008

## SECTION 1: DEMOLITION

ITEM	QTY.	UNIT	COST	UNIT	TOTAL
<b>DEMOLITION</b>					
Saw Cut and Remove Asphalt	-	sf	\$ 2.00	sf	\$ -
Existing Curb and Gutter	-	lf	\$ 11.50	lf	\$ -
Existing Trees and Shrubs in Poor Condition	-	ea.	\$ 300.00	ea.	\$ -
Existing Concrete Sidewalk	-	sf	\$ 3.50	sf	\$ -
Existing Lights	-	ea.	\$ 1,500.00	ea.	\$ -
Existing Tree Grates	-	ea.	\$ 250.00	ea.	\$ -
Excess Soil Haul-Off	-	cy	\$ 25.00	cy	\$ -
<b>Section 1: Demolition Sub-Total</b>					<b>\$0</b>

## SECTION 2: SITE MATERIALS

ITEM	QTY.	UNIT	COST	UNIT	TOTAL
<b>PAVING MATERIALS</b>					
Concrete Curb and Gutter	-	lf	\$ 35.00	lf	\$ -
Clay Pavers on Concrete- Sidewalk	-	sf	\$ 20.00	lf	\$ -
Concrete Walk	-	sf	\$ 9.00	sf	\$ -
Asphalt Paving	-	sf	\$ 5.50	sf	\$ -
Striping for Parking	-	lf	\$ 2.00	lf	\$ -
Curbed Planter	-	lf	\$ 60.00	lf	\$ -
Tree Grates	-	ea.	\$ 4,500.00	ea.	\$ -
Pedestrian Lights	7	ea.	\$ 4,500.00	ea.	\$ 31,500.00
Intersection Cut-off Lights	1	ea.	\$ 10,000.00	ea.	\$ 10,000.00
Movable Planters	-	ea.	\$ 1,000.00	ea.	\$ -
Benches	-	ea.	\$ 3,000.00	ea.	\$ -
Trash Receptacle	-	ea.	\$ 1,500.00	ea.	\$ -
Tactile Paving	-	sf	\$ 15.00	sf	\$ -
Bike Racks	-	ea.	\$ 500.00	ea.	\$ -
Bollards	-	ea.	\$ 1,000.00	ea.	\$ -
<b>SITE WORK</b>					
Structural Soil	-	cy	\$ 125.00	cy	\$ -
Planting Soil	-	cy	\$ 50.00	cy	\$ -
Drainage	-	lf	\$ 9.00	lf	\$ -
Irrigation	-	ls	\$ 15,000.00	ls	\$ -
Electric at Tree Grates	-	ea.	\$ 350.00	ea.	\$ -
Storm Lateral Connection - Two per Block	-	ea.	\$ 250.00	ea.	\$ -
<b>Section 2: Site Materials Sub-Total</b>					<b>\$41,500</b>

## SECTION 3: SOFTSCAPE

ITEM	QTY.	UNIT	COST	UNIT	TOTAL
Shredded Hardwood Mulch	-	cy	\$ 60.00	cy	\$ -
Gravel in Tree Grates	-	cy	\$ 80.00	cy	\$ -
Shade Trees	-	ea.	\$ 750.00	ea.	\$ -
Additional Plant Material (shrubs/perennials/annuals)	-	ls	\$ 15,000.00	ls	\$ -
<b>Section 3: Softscape Sub-Total</b>					<b>\$0</b>

## SECTION 4: SIGNAGE

ITEM	QTY.	UNIT	COST	UNIT	TOTAL
Kiosk	-	ea.	\$ 15,000.00	ea.	\$ -
District Gateway	-	ea.	\$ 15,000.00	ea.	\$ -
Parking Directional	-	ea.	\$ 2,500.00	ea.	\$ -
Parking Identity	-	ea.	\$ 2,500.00	ea.	\$ -
Regulatory Sign on Decorative Pole	-	ea.	\$ 1,100.00	ea.	\$ -
Street Sign on Decorative Pole	-	ea.	\$ 1,100.00	ea.	\$ -
<b>Section 3: Softscape Sub-Total</b>					<b>\$0</b>

<b>PROJECT SUBTOTAL</b>	<b>\$41,500</b>
<b>Project Fees + Contingency @ 20%</b>	<b>\$8,300</b>
<b>PROJECT TOTAL</b>	<b>\$49,800</b>

Source: THE LAKOTA GROUP

# Winnetka Streetscape - Cost Estimates

8B - Chestnut (East Side) Elm to Oak

October 2008

## SECTION 1: DEMOLITION

ITEM	QTY.	UNIT	COST	UNIT	TOTAL
<b>DEMOLITION</b>					
Saw Cut and Remove Asphalt	3,135	sf	\$ 2.00	sf	\$ 6,270.00
Existing Curb and Gutter	1,045	lf	\$ 11.50	lf	\$ 12,017.50
Existing Trees and Shrubs in Poor Condition	7	ea.	\$ 300.00	ea.	\$ 2,100.00
Existing Concrete Sidewalk	3,835	sf	\$ 3.50	sf	\$ 13,422.50
Existing Lights	2	ea.	\$ 1,500.00	ea.	\$ 3,000.00
Existing Tree Grates	6	ea.	\$ 250.00	ea.	\$ 1,500.00
Excess Soil Haul-Off	160	cy	\$ 25.00	cy	\$ 4,000.00
<b>Section 1: Demolition Sub-Total</b>					<b>\$42,310</b>

## SECTION 2: SITE MATERIALS

ITEM	QTY.	UNIT	COST	UNIT	TOTAL
<b>PAVING MATERIALS</b>					
Concrete Curb and Gutter	1,045	lf	\$ 35.00	lf	\$ 36,575.00
Clay Pavers on Concrete- Sidewalk	2,600	sf	\$ 20.00	lf	\$ 52,000.00
Concrete Walk	1,535	sf	\$ 9.00	sf	\$ 13,815.00
Asphalt Paving	3,135	sf	\$ 5.50	sf	\$ 17,242.50
Striping for Parking	480	lf	\$ 2.00	lf	\$ 960.00
Curbed Planter	195	lf	\$ 60.00	lf	\$ 11,700.00
Tree Grates	8	ea.	\$ 4,500.00	ea.	\$ 36,000.00
Pedestrian Lights	7	ea.	\$ 4,500.00	ea.	\$ 31,500.00
Intersection Cut-off Lights	1	ea.	\$ 10,000.00	ea.	\$ 10,000.00
Movable Planters	10	ea.	\$ 1,000.00	ea.	\$ 10,000.00
Benches	-	ea.	\$ 3,000.00	ea.	\$ -
Trash Receptacle	1	ea.	\$ 1,500.00	ea.	\$ 1,500.00
Tactile Paving	78	sf	\$ 15.00	sf	\$ 1,170.00
Bike Racks	-	ea.	\$ 500.00	ea.	\$ -
Bollards	-	ea.	\$ 1,000.00	ea.	\$ -
<b>SITE WORK</b>					
Structural Soil	160	cy	\$ 125.00	cy	\$ 20,000.00
Planting Soil	22	cy	\$ 50.00	cy	\$ 1,100.00
Drainage	1,200	lf	\$ 9.00	lf	\$ 10,800.00
Irrigation	1	ls	\$ 15,000.00	ls	\$ 15,000.00
Electric at Tree Grates	8	ea.	\$ 350.00	ea.	\$ 2,800.00
Storm Lateral Connection - Two per Block	2	ea.	\$ 250.00	ea.	\$ 500.00
<b>Section 2: Site Materials Sub-Total</b>					<b>\$272,663</b>

## SECTION 3: SOFTSCAPE

ITEM	QTY.	UNIT	COST	UNIT	TOTAL
Shredded Hardwood Mulch	2	cy	\$ 60.00	cy	\$ 120.00
Gravel in Tree Grates	1	cy	\$ 80.00	cy	\$ 80.00
Shade Trees	5	ea.	\$ 750.00	ea.	\$ 3,750.00
Additional Plant Material (shrubs/perennials/annuals)	1	ls	\$ 15,000.00	ls	\$ 15,000.00
<b>Section 3: Softscape Sub-Total</b>					<b>\$18,950</b>

## SECTION 4: SIGNAGE

ITEM	QTY.	UNIT	COST	UNIT	TOTAL
Kiosk	-	ea.	\$ 15,000.00	ea.	\$ -
District Gateway	-	ea.	\$ 15,000.00	ea.	\$ -
Parking Directional	-	ea.	\$ 2,500.00	ea.	\$ -
Parking Identity	-	ea.	\$ 2,500.00	ea.	\$ -
Regulatory Sign on Decorative Pole	2	ea.	\$ 1,100.00	ea.	\$ 2,200.00
Street Sign on Decorative Pole	3	ea.	\$ 1,100.00	ea.	\$ 3,300.00
<b>Section 3: Softscape Sub-Total</b>					<b>\$5,500</b>

**PROJECT SUBTOTAL** **\$339,423**

Project Fees + Contingency @ 20% **\$67,885**

**PROJECT TOTAL** **\$407,307**

Source: THE LAKOTA GROUP

# Winnetka Streetscape - Cost Estimate

9A - Elm Street (north side) Church to Chestnut Street - Lights Only

October 2008

## SECTION 1: DEMOLITION

ITEM	QTY.	UNIT	COST	UNIT	TOTAL
<b>DEMOLITION</b>					
Saw Cut and Remove Asphalt	-	sf	\$ 2.00	sf	\$ -
Existing Curb and Gutter	-	lf	\$ 11.50	lf	\$ -
Existing Trees and Shrubs in Poor Condition	-	ea.	\$ 300.00	ea.	\$ -
Existing Concrete Sidewalk	-	sf	\$ 3.50	sf	\$ -
Existing Lights	-	ea.	\$ 1,500.00	ea.	\$ -
Existing Tree Grates	-	ea.	\$ 250.00	ea.	\$ -
Excess Soil Haul-Off	-	cy	\$ 25.00	cy	\$ -
<b>Section 1: Demolition Sub-Total</b>					<b>\$0</b>

## SECTION 2: SITE MATERIALS

ITEM	QTY.	UNIT	COST	UNIT	TOTAL
<b>PAVING MATERIALS</b>					
Concrete Curb and Gutter	-	lf	\$ 35.00	lf	\$ -
Clay Pavers on Concrete- Sidewalk	-	sf	\$ 20.00	lf	\$ -
Concrete Walk	-	sf	\$ 9.00	sf	\$ -
Asphalt Paving	-	sf	\$ 5.50	sf	\$ -
Striping for Parking	-	lf	\$ 2.00	lf	\$ -
Curbed Planter	-	lf	\$ 60.00	lf	\$ -
Tree Grates	-	ea.	\$ 4,500.00	ea.	\$ -
Pedestrian Lights	4	ea.	\$ 4,500.00	ea.	\$ 18,000.00
Intersection Cut-off Lights	-	ea.	\$ 10,000.00	ea.	\$ -
Movable Planters	-	ea.	\$ 1,000.00	ea.	\$ -
Benches	-	ea.	\$ 3,000.00	ea.	\$ -
Trash Receptacle	-	ea.	\$ 1,500.00	ea.	\$ -
Tactile Paving	-	sf	\$ 15.00	sf	\$ -
Bike Racks	-	ea.	\$ 500.00	ea.	\$ -
Bollards	-	ea.	\$ 1,000.00	ea.	\$ -
<b>SITE WORK</b>					
Structural Soil	-	cy	\$ 125.00	cy	\$ -
Planting Soil	-	cy	\$ 50.00	cy	\$ -
Drainage	-	lf	\$ 9.00	lf	\$ -
Irrigation	-	ls	\$ 20,000.00	ls	\$ -
Electric at Tree Grates	-	ea.	\$ 350.00	ea.	\$ -
Storm Lateral Connection - Two per Block	-	ea.	\$ 250.00	ea.	\$ -
<b>Section 2: Site Materials Sub-Total</b>					<b>\$18,000</b>

## SECTION 3: SOFTSCAPE

ITEM	QTY.	UNIT	COST	UNIT	TOTAL
Shredded Hardwood Mulch	-	cy	\$ 60.00	cy	\$ -
Gravel in Tree Grates	-	cy	\$ 80.00	cy	\$ -
Shade Trees	-	ea.	\$ 750.00	ea.	\$ -
Additional Plant Material (shrubs/perennials/annuals)	-	ls	\$ 15,000.00	ls	\$ -
<b>Section 3: Softscape Sub-Total</b>					<b>\$0</b>

## SECTION 4: SIGNAGE

ITEM	QTY.	UNIT	COST	UNIT	TOTAL
Kiosk	-	ea.	\$ 15,000.00	ea.	\$ -
District Gateway	-	ea.	\$ 15,000.00	ea.	\$ -
Parking Directional	-	ea.	\$ 2,500.00	ea.	\$ -
Parking Identity	-	ea.	\$ 2,500.00	ea.	\$ -
Regulatory Sign on Decorative Pole	-	ea.	\$ 1,100.00	ea.	\$ -
Street Sign on Decorative Pole	-	ea.	\$ 1,100.00	ea.	\$ -
<b>Section 3: Softscape Sub-Total</b>					<b>\$0</b>

<b>PROJECT SUBTOTAL</b>	<b>\$18,000</b>
<b>Project Fees + Contingency @ 20%</b>	<b>\$3,600</b>
<b>PROJECT TOTAL</b>	<b>\$21,600</b>

Source: THE LAKOTA GROUP

**Winnetka Streetscape – Cost Estimate**

9B – Elm Street (north side) Church to Chestnut Street

October 2008

**SECTION 1: DEMOLITION**

ITEM	QTY.	UNIT	COST	UNIT	TOTAL
<b>DEMOLITION</b>					
Saw Cut and Remove Asphalt	870	sf	\$ 2.00	sf	\$ 1,740.00
Existing Curb and Gutter	290	lf	\$ 11.50	lf	\$ 3,335.00
Existing Trees and Shrubs in Poor Condition	-	ea.	\$ 300.00	ea.	\$ -
Existing Concrete Sidewalk	1,540	sf	\$ 3.50	sf	\$ 5,390.00
Existing Lights	1	ea.	\$ 1,500.00	ea.	\$ 1,500.00
Existing Tree Grates	-	ea.	\$ 250.00	ea.	\$ -
Excess Soil Haul-Off	50	cy	\$ 25.00	cy	\$ 1,250.00
<b>Section 1: Demolition Sub-Total</b>					<b>\$13,215</b>

**SECTION 2: SITE MATERIALS**

ITEM	QTY.	UNIT	COST	UNIT	TOTAL
<b>PAVING MATERIALS</b>					
Concrete Curb and Gutter	290	lf	\$ 35.00	lf	\$ 10,150.00
Clay Pavers on Concrete- Sidewalk	560	sf	\$ 20.00	lf	\$ 11,200.00
Concrete Walk	980	sf	\$ 9.00	sf	\$ 8,820.00
Asphalt Paving	870	sf	\$ 5.50	sf	\$ 4,785.00
Striping for Parking	331	lf	\$ 2.00	lf	\$ 661.00
Curbed Planter	114	lf	\$ 60.00	lf	\$ 6,840.00
Tree Grates	1	ea.	\$ 4,500.00	ea.	\$ 4,500.00
Pedestrian Lights	4	ea.	\$ 4,500.00	ea.	\$ 18,000.00
Intersection Cut-off Lights	-	ea.	\$ 10,000.00	ea.	\$ -
Movable Planters	-	ea.	\$ 1,000.00	ea.	\$ -
Benches	2	ea.	\$ 3,000.00	ea.	\$ 6,000.00
Trash Receptacle	2	ea.	\$ 1,500.00	ea.	\$ 3,000.00
Tactile Paving	10	sf	\$ 15.00	sf	\$ 150.00
Bike Racks	-	ea.	\$ 500.00	ea.	\$ -
Bollards	-	ea.	\$ 1,000.00	ea.	\$ -
<b>SITE WORK</b>					
Structural Soil	40	cy	\$ 125.00	cy	\$ 5,000.00
Planting Soil	26	cy	\$ 50.00	cy	\$ 1,300.00
Drainage	320	lf	\$ 9.00	lf	\$ 2,880.00
Irrigation	1	ls	\$ 5,000.00	ls	\$ 5,000.00
Electric at Tree Grates	1	ea.	\$ 350.00	ea.	\$ 350.00
Storm Lateral Connection – Two per Block	1	ea.	\$ 250.00	ea.	\$ 250.00
<b>Section 2: Site Materials Sub-Total</b>					<b>\$88,886</b>

**SECTION 3: SOFTSCAPE**

ITEM	QTY.	UNIT	COST	UNIT	TOTAL
Shredded Hardwood Mulch	3	cy	\$ 60.00	cy	\$ 180.00
Gravel in Tree Grates	1	cy	\$ 80.00	cy	\$ 80.00
Shade Trees	1	ea.	\$ 750.00	ea.	\$ 750.00
Additional Plant Material (shrubs/perennials/annuals)	1	ls	\$ 5,000.00	ls	\$ 5,000.00
<b>Section 3: Softscape Sub-Total</b>					<b>\$6,010</b>

**SECTION 4: SIGNAGE**

ITEM	QTY.	UNIT	COST	UNIT	TOTAL
Kiosk	-	ea.	\$ 15,000.00	ea.	\$ -
District Gateway	-	ea.	\$ 15,000.00	ea.	\$ -
Parking Directional	1	ea.	\$ 2,500.00	ea.	\$ 2,500.00
Parking Identity	-	ea.	\$ 2,500.00	ea.	\$ -
Regulatory Sign on Decorative Pole	2	ea.	\$ 1,100.00	ea.	\$ 2,200.00
Street Sign on Decorative Pole	-	ea.	\$ 1,100.00	ea.	\$ -
<b>Section 3: Softscape Sub-Total</b>					<b>\$4,700</b>

**PROJECT SUBTOTAL****\$112,811**

Project Fees + Contingency @ 20%

**\$22,562****PROJECT TOTAL****\$135,373**

Source: THE LAKOTA GROUP

# Winnetka Streetscape – Cost Estimate

11 – Northwest Corner of Tower and Green Bay

October 2008

## SECTION 1: DEMOLITION

ITEM	QTY.	UNIT	COST	UNIT	TOTAL
<b>DEMOLITION</b>					
Saw Cut and Remove Asphalt	-	sf	\$ 2.00	sf	\$ -
Existing Curb and Gutter	-	lf	\$ 11.50	lf	\$ -
Existing Trees and Shrubs in Poor Condition	-	ea.	\$ 300.00	ea.	\$ -
Existing Concrete Sidewalk	1,957	sf	\$ 3.50	sf	\$ 6,849.50
Existing Lights	2	ea.	\$ 1,500.00	ea.	\$ 3,000.00
Existing Tree Grates	-	ea.	\$ 250.00	ea.	\$ -
Excess Soil Haul-Off	12	cy	\$ 25.00	cy	\$ 300.00
<b>Section 1: Demolition Sub-Total</b>					<b>\$10,150</b>

## SECTION 2: SITE MATERIALS

ITEM	QTY.	UNIT	COST	UNIT	TOTAL
<b>PAVING MATERIALS</b>					
Concrete Curb and Gutter	-	lf	\$ 35.00	lf	\$ -
Clay Pavers on Concrete- Sidewalk	1,115	sf	\$ 20.00	lf	\$ 22,300.00
Concrete Walk	842	sf	\$ 9.00	sf	\$ 7,578.00
Asphalt Paving	-	sf	\$ 5.50	sf	\$ -
Striping for Parking	-	lf	\$ 2.00	lf	\$ -
Curbed Planter	72	lf	\$ 60.00	lf	\$ 4,320.00
Tree Grates	2	ea.	\$ 4,500.00	ea.	\$ 9,000.00
Pedestrian Lights	2	ea.	\$ 4,500.00	ea.	\$ 9,000.00
Intersection Cut-off Lights	1	ea.	\$ 10,000.00	ea.	\$ 10,000.00
Movable Planters	4	ea.	\$ 1,000.00	ea.	\$ 4,000.00
Benches	2	ea.	\$ 3,000.00	ea.	\$ 6,000.00
Trash Receptacle	1	ea.	\$ 1,500.00	ea.	\$ 1,500.00
Tactile Paving	16	sf	\$ 15.00	sf	\$ 240.00
Bike Racks	-	ea.	\$ 500.00	ea.	\$ -
Bollards	4	ea.	\$ 1,000.00	ea.	\$ 4,000.00
<b>SITE WORK</b>					
Structural Soil	12	cy	\$ 125.00	cy	\$ 1,500.00
Planting Soil	5	cy	\$ 50.00	cy	\$ 250.00
Drainage	-	lf	\$ 9.00	lf	\$ -
Irrigation	1	ls	\$ 2,000.00	ls	\$ 2,000.00
Electric at Tree Grates	2	ea.	\$ 350.00	ea.	\$ 700.00
Storm Lateral Connection – Two per Block	2	ea.	\$ 250.00	ea.	\$ 500.00
<b>Section 2: Site Materials Sub-Total</b>					<b>\$82,888</b>

## SECTION 3: SOFTSCAPE

ITEM	QTY.	UNIT	COST	UNIT	TOTAL
Shredded Hardwood Mulch	2	cy	\$ 60.00	cy	\$ 120.00
Gravel in Tree Grates	1	cy	\$ 80.00	cy	\$ 40.00
Shade Trees	2	ea.	\$ 750.00	ea.	\$ 1,500.00
Additional Plant Material (shrubs/perennials/annuals)	1	ls	\$ 3,000.00	ls	\$ 3,000.00
<b>Section 3: Softscape Sub-Total</b>					<b>\$4,660</b>

## SECTION 4: SIGNAGE

ITEM	QTY.	UNIT	COST	UNIT	TOTAL
Kiosk	-	ea.	\$ 15,000.00	ea.	\$ -
District Gateway	-	ea.	\$ 15,000.00	ea.	\$ -
Parking Directional	-	ea.	\$ 2,500.00	ea.	\$ -
Parking Identity	-	ea.	\$ 2,500.00	ea.	\$ -
Regulatory Sign on Decorative Pole	-	ea.	\$ 1,100.00	ea.	\$ -
Street Sign on Decorative Pole	-	ea.	\$ 1,100.00	ea.	\$ -
<b>Section 3: Softscape Sub-Total</b>					<b>\$0</b>

<b>PROJECT SUBTOTAL</b>	<b>\$97,698</b>
<b>Project Fees + Contingency @ 20%</b>	<b>\$19,540</b>
<b>PROJECT TOTAL</b>	<b>\$117,237</b>

Source: THE LAKOTA GROUP

# Winnetka Streetscape - Cost Estimate

12 - Rear of Talbots Building to Green Bay

October 2008

## SECTION 1: DEMOLITION

ITEM	QTY.	UNIT	COST	UNIT	TOTAL
<b>DEMOLITION</b>					
Saw Cut and Remove Asphalt	2,100	sf	\$ 2.00	sf	\$ 4,200.00
Existing Curb and Gutter	700	lf	\$ 11.50	lf	\$ 8,050.00
Existing Trees and Shrubs in Poor Condition	6	ea.	\$ 300.00	ea.	\$ 1,800.00
Existing Concrete Sidewalk	5,350	sf	\$ 3.50	sf	\$ 18,725.00
Existing Lights	3	ea.	\$ 1,500.00	ea.	\$ 4,500.00
Existing Tree Grates	6	ea.	\$ 250.00	ea.	\$ 1,500.00
Excess Soil Haul-Off	250	cy	\$ 25.00	cy	\$ 6,250.00
<b>Section 1: Demolition Sub-Total</b>					<b>\$45,025</b>

## SECTION 2: SITE MATERIALS

ITEM	QTY.	UNIT	COST	UNIT	TOTAL
<b>PAVING MATERIALS</b>					
Concrete Curb and Gutter	700	lf	\$ 35.00	lf	\$ 24,500.00
Clay Pavers on Concrete- Sidewalk	1,100	sf	\$ 20.00	lf	\$ 22,000.00
Concrete Walk	3,250	sf	\$ 9.00	sf	\$ 29,250.00
Asphalt Paving	2,100	sf	\$ 5.50	sf	\$ 11,550.00
Striping for Parking	40	lf	\$ 2.00	lf	\$ 80.00
Curbed Planter	200	lf	\$ 60.00	lf	\$ 12,000.00
Tree Grates	3	ea.	\$ 4,500.00	ea.	\$ 13,500.00
Pedestrian Lights	8	ea.	\$ 4,500.00	ea.	\$ 36,000.00
Intersection Cut-off Lights	-	ea.	\$ 10,000.00	ea.	\$ -
Movable Planters	6	ea.	\$ 1,000.00	ea.	\$ 6,000.00
Benches	-	ea.	\$ 3,000.00	ea.	\$ -
Trash Receptacle	2	ea.	\$ 1,500.00	ea.	\$ 3,000.00
Tactile Paving	40	sf	\$ 15.00	sf	\$ 600.00
Bike Racks	-	ea.	\$ 500.00	ea.	\$ -
Bollards	-	ea.	\$ 1,000.00	ea.	\$ -
<b>SITE WORK</b>					
Structural Soil	70	cy	\$ 125.00	cy	\$ 8,750.00
Planting Soil	65	cy	\$ 50.00	cy	\$ 3,250.00
Drainage	150	lf	\$ 9.00	lf	\$ 1,350.00
Irrigation	1	ls	\$ 15,000.00	ls	\$ 15,000.00
Electric at Tree Grates	3	ea.	\$ 350.00	ea.	\$ 1,050.00
Storm Lateral Connection - Two per Block	2	ea.	\$ 250.00	ea.	\$ 500.00
<b>Section 2: Site Materials Sub-Total</b>					<b>\$188,380</b>

## SECTION 3: SOFTSCAPE

ITEM	QTY.	UNIT	COST	UNIT	TOTAL
Shredded Hardwood Mulch	8	cy	\$ 60.00	cy	\$ 480.00
Gravel in Tree Grates	2	cy	\$ 80.00	cy	\$ 160.00
Shade Trees	5	ea.	\$ 750.00	ea.	\$ 3,750.00
Additional Plant Material (shrubs/perennials/annuals)	1	ls	\$ 15,000.00	ls	\$ 15,000.00
<b>Section 3: Softscape Sub-Total</b>					<b>\$19,390</b>

## SECTION 4: SIGNAGE

ITEM	QTY.	UNIT	COST	UNIT	TOTAL
Kiosk	-	ea.	\$ 15,000.00	ea.	\$ -
District Gateway	-	ea.	\$ 15,000.00	ea.	\$ -
Parking Directional	2	ea.	\$ 2,500.00	ea.	\$ 5,000.00
Parking Identity	-	ea.	\$ 2,500.00	ea.	\$ -
Regulatory Sign on Decorative Pole	4	ea.	\$ 1,100.00	ea.	\$ 4,400.00
Street Sign on Decorative Pole	2	ea.	\$ 1,100.00	ea.	\$ 2,200.00
<b>Section 3: Softscape Sub-Total</b>					<b>\$11,600</b>

**PROJECT SUBTOTAL** **\$264,395**

Project Fees + Contingency @ 20% **\$52,879**

**PROJECT TOTAL** **\$317,274**

Source: THE LAKOTA GROUP

# Winnetka Streetscape - Cost Estimate

13 - Lincoln Avenue (Both Sides) Elm to Oak

October 2008

## SECTION 1: DEMOLITION

ITEM	QTY.	UNIT	COST	UNIT	TOTAL
<b>DEMOLITION</b>					
Saw Cut and Remove Asphalt	4,074	sf	\$ 2.00	sf	\$ 8,148.00
Existing Curb and Gutter	1,358	lf	\$ 11.50	lf	\$ 15,617.00
Existing Trees and Shrubs in Poor Condition	7	ea.	\$ 300.00	ea.	\$ 2,100.00
Existing Concrete Sidewalk	7,680	sf	\$ 3.50	sf	\$ 26,880.00
Existing Lights	2	ea.	\$ 1,500.00	ea.	\$ 3,000.00
Existing Tree Grates	6	ea.	\$ 250.00	ea.	\$ 1,500.00
Excess Soil Haul-Off	35	cy	\$ 25.00	cy	\$ 875.00
<b>Section 1: Demolition Sub-Total</b>					<b>\$58,120</b>

## SECTION 2: SITE MATERIALS

ITEM	QTY.	UNIT	COST	UNIT	TOTAL
<b>PAVING MATERIALS</b>					
Concrete Curb and Gutter	1,358	lf	\$ 35.00	lf	\$ 47,530.00
Clay Pavers on Concrete- Sidewalk	4,122	sf	\$ 20.00	lf	\$ 82,440.00
Concrete Walk	8,880	sf	\$ 9.00	sf	\$ 79,920.00
Asphalt Paving	4,074	sf	\$ 5.50	sf	\$ 22,407.00
Striping for Parking	850	lf	\$ 2.00	lf	\$ 1,700.00
Curbed Planter	327	lf	\$ 60.00	lf	\$ 19,620.00
Tree Grates	6	ea.	\$ 4,500.00	ea.	\$ 27,000.00
Pedestrian Lights	13	ea.	\$ 4,500.00	ea.	\$ 58,500.00
Intersection Cut-off Lights	2	ea.	\$ 10,000.00	ea.	\$ 20,000.00
Movable Planters	2	ea.	\$ 1,000.00	ea.	\$ 2,000.00
Benches	6	ea.	\$ 3,000.00	ea.	\$ 18,000.00
Trash Receptacle	3	ea.	\$ 1,500.00	ea.	\$ 4,500.00
Tactile Paving	88	sf	\$ 15.00	sf	\$ 1,320.00
Bike Racks	-	ea.	\$ 500.00	ea.	\$ -
Bollards	-	ea.	\$ 1,000.00	ea.	\$ -
<b>SITE WORK</b>					
Structural Soil	35	cy	\$ 125.00	cy	\$ 4,375.00
Planting Soil	25	cy	\$ 50.00	cy	\$ 1,250.00
Drainage	100	lf	\$ 9.00	lf	\$ 900.00
Irrigation	1	ls	\$ 25,000.00	ls	\$ 25,000.00
Electric at Tree Grates	6	ea.	\$ 350.00	ea.	\$ 2,100.00
Storm Lateral Connection - Two per Block	4	ea.	\$ 250.00	ea.	\$ 1,000.00
<b>Section 2: Site Materials Sub-Total</b>					<b>\$419,562</b>

## SECTION 3: SOFTSCAPE

ITEM	QTY.	UNIT	COST	UNIT	TOTAL
Shredded Hardwood Mulch	13	cy	\$ 60.00	cy	\$ 780.00
Gravel in Tree Grates	1	cy	\$ 80.00	cy	\$ 80.00
Shade Trees	6	ea.	\$ 750.00	ea.	\$ 4,500.00
Additional Plant Material (shrubs/perennials/annuals)	1	ls	\$ 15,000.00	ls	\$ 15,000.00
<b>Section 3: Softscape Sub-Total</b>					<b>\$20,360</b>

## SECTION 4: SIGNAGE

ITEM	QTY.	UNIT	COST	UNIT	TOTAL
Kiosk	-	ea.	\$ 15,000.00	ea.	\$ -
District Gateway	-	ea.	\$ 15,000.00	ea.	\$ -
Parking Directional	-	ea.	\$ 2,500.00	ea.	\$ -
Parking Identity	-	ea.	\$ 2,500.00	ea.	\$ -
Regulatory Sign on Decorative Pole	-	ea.	\$ 1,100.00	ea.	\$ -
Street Sign on Decorative Pole	-	ea.	\$ 1,100.00	ea.	\$ -
<b>Section 3: Softscape Sub-Total</b>					<b>\$0</b>

<b>PROJECT SUBTOTAL</b>	<b>\$498,042</b>
<b>Project Fees + Contingency @ 20%</b>	<b>\$99,608</b>
<b>PROJECT TOTAL</b>	<b>\$597,650</b>

Source: THE LAKOTA GROUP

# Winnetka Streetscape - Cost Estimate

14 - Hubbard Woods Planters

October 2008

## SECTION 1: DEMOLITION

ITEM	QTY.	UNIT	COST	UNIT	TOTAL
<b>DEMOLITION</b>					
Saw Cut and Remove Asphalt	-	sf	\$ 2.00	sf	\$ -
Existing Curb and Gutter	-	lf	\$ 11.50	lf	\$ -
Existing Trees and Shrubs in Poor Condition	-	ea.	\$ 300.00	ea.	\$ -
Existing Concrete Sidewalk	-	sf	\$ 3.50	sf	\$ -
Existing Lights	-	ea.	\$ 1,500.00	ea.	\$ -
Existing Tree Grates	-	ea.	\$ 250.00	ea.	\$ -
Excess Soil Haul-Off	-	cy	\$ 25.00	cy	\$ -
<b>Section 1: Demolition Sub-Total</b>					<b>\$0</b>

## SECTION 2: SITE MATERIALS

ITEM	QTY.	UNIT	COST	UNIT	TOTAL
<b>PAVING MATERIALS</b>					
Concrete Curb and Gutter	-	lf	\$ 35.00	lf	\$ -
Clay Pavers on Concrete- Sidewalk	-	sf	\$ 20.00	lf	\$ -
Concrete Walk	-	sf	\$ 9.00	sf	\$ -
Asphalt Paving	-	sf	\$ 5.50	sf	\$ -
Striping for Parking	-	lf	\$ 2.00	lf	\$ -
Curbed Planter	-	lf	\$ 60.00	lf	\$ -
Tree Grates	-	ea.	\$ 4,500.00	ea.	\$ -
Pedestrian Lights	-	ea.	\$ 4,500.00	ea.	\$ -
Intersection Cut-off Lights	-	ea.	\$ 10,000.00	ea.	\$ -
Movable Planters	22	ea.	\$ 1,000.00	ea.	\$ 22,000.00
Benches	-	ea.	\$ 3,000.00	ea.	\$ -
Trash Receptacle	-	ea.	\$ 1,500.00	ea.	\$ -
Tactile Paving	-	sf	\$ 15.00	sf	\$ -
Bike Racks	-	ea.	\$ 500.00	ea.	\$ -
Bollards	-	ea.	\$ 1,000.00	ea.	\$ -
<b>SITE WORK</b>					
Structural Soil	-	cy	\$ 125.00	cy	\$ -
Planting Soil	-	cy	\$ 50.00	cy	\$ -
Drainage	-	lf	\$ 9.00	lf	\$ -
Irrigation	-	ls	\$ 20,000.00	ls	\$ -
Electric at Tree Grates	-	ea.	\$ 350.00	ea.	\$ -
Storm Lateral Connection - Two per Block	-	ea.	\$ 250.00	ea.	\$ -
<b>Section 2: Site Materials Sub-Total</b>					<b>\$22,000</b>

## SECTION 3: SOFTSCAPE

ITEM	QTY.	UNIT	COST	UNIT	TOTAL
Shredded Hardwood Mulch	-	cy	\$ 60.00	cy	\$ -
Gravel in Tree Grates	-	cy	\$ 80.00	cy	\$ -
Shade Trees	-	ea.	\$ 750.00	ea.	\$ -
Additional Plant Material (shrubs/perennials/annuals)	-	ls	\$ -	ls	\$ -
<b>Section 3: Softscape Sub-Total</b>					<b>\$0</b>

## SECTION 4: SIGNAGE

ITEM	QTY.	UNIT	COST	UNIT	TOTAL
Kiosk	-	ea.	\$ 15,000.00	ea.	\$ -
District Gateway	-	ea.	\$ 15,000.00	ea.	\$ -
Parking Directional	-	ea.	\$ 2,500.00	ea.	\$ -
Parking Identity	-	ea.	\$ 2,500.00	ea.	\$ -
Regulatory Sign on Decorative Pole	-	ea.	\$ 1,100.00	ea.	\$ -
Street Sign on Decorative Pole	-	ea.	\$ 1,100.00	ea.	\$ -
<b>Section 3: Softscape Sub-Total</b>					<b>\$0</b>

<b>PROJECT SUBTOTAL</b>	<b>\$22,000</b>
<b>Project Fees + Contingency @ 20%</b>	<b>\$4,400</b>
<b>PROJECT TOTAL</b>	<b>\$26,400</b>

Source: THE LAKOTA GROUP